

## TECHNICAL FEATURES

### GENERAL INFORMATION

Type desktop/console	Console
Technology	Semiconductor laser, with amorphous silicon technology
Resolution	600 x 600 dpi
Motor speed	20/10 cpm A4/A3
Duplex unit	Front/back 50-sheet RADF
Document feeder	Paper weight: simplex 45-160 g/m <sup>2</sup> duplex: 50-120 g/m <sup>2</sup>
Greyscale	256 levels
Electric absorption	Maximum configuration: 1571 W Print/copy: 557 W (d-Color MF2001) Stand-by: 115 W (d-Color MF2001) Power-saving mode: 0.9 W (standard configuration)
Warm-up time	< 45 secondi
Power	220 - 240 Vac, 50/60 Hz
Dimensions (LxWxH)	590 x 590 x 748 mm
Weight	80 kg (without options)
Consumables	Toner Cartridge: Black (B0990): up to 12,000 pages CMY (B0991-2-3): up to 6,000 pages Maintenance Kit: MK-A (B0994): up to 200,000 pages MK-B (B0995): up to 200,000 pages
Application management	JAWS platform (Java And Web Solutions)

### COPIER

Scanning system	Scanner, stationary type
Resolution	600 x 600 dpi
First copy time	<11.7 seconds
RAM	1,536 MB, expandable to 2,048 MB
Max / min copy format	A3/A6R
Format originals	A3 max
Management incoming paper	Up to 100 sheets from by-pass (80 g/m <sup>2</sup> ) Up to 500 sheets from tray (80 g/m <sup>2</sup> )
Paper weight	Max: 60-256 g/m <sup>2</sup>
Copy collect capacity	250 sheets (80 g/m <sup>2</sup> ) 100 sheets from job separator
Zoom	25 - 400% (step 1%)

### PRINTER

Print speed	20/10 cpm A4/A3
CPU	Power PC 464 - 800MHz
Resolution	600 x 600 dpi
Operating systems	Windows 98, ME, NT 4.0, 2000, XP, Vista, 7, Server 2000, Server 2003, Server 2008, Server 2008 R.2, Mac OS X 10.5 or later
Languages	PCL6, PCL5c, PCL XL, KPDL3 (PS 3 compatible, PDF direct printing support)
Fonts	101 outline (PCL6), 144 PostScript (KPDL3), 45 one-dimensional barcodes and 1 two-dimensional barcode (PDF-417)
Interfaces	1 x High speed serial interface USB 2.0, 1 x Fast Ethernet 10/100/1000BaseTX, 2 x USB 1.1 Host
Stapling	With optional finisher DF-470

### SCANNER

Simplex scan speed	40 ipm B/W - Colour (200 dpi) 40 ipm B/W - Colour (300 dpi) 20 ipm B/W - Colour (600 dpi)
Resolution	600 dpi, 400 dpi, 300 dpi, 200 dpi 200 x 100 dpi, 200 x 400 dpi
Colour modes	Colour, B/W, Text, Photo, Draft, OCR
Scan modes	Text, Photo, Text+Photo, OCR
Max scan format	A3
Image format	TIFF, PDF/A, XPS, JPEG
Network protocols	TCP/IP
Interfaces	10/100 Base-TX1000Base
TWAIN	Boxless TWAIN
Drivers	Twain and WIA
Functions	Scan to PC, Scan to e-mail, Scan to FTP, Scan to USB, TWAIN, WIA, WSD, Scan to SMB
Operating systems	Windows XP, Vista, 7, Server 2003, Server 2008, Server 2008 R.2

### FAX SYSTEM (U) optional

Resolution (max)	Ultrafine
Compatibility	ITU-T Super G3
Functions	Network fax
Data compression	JBIG, MMR, MR, MH
Greyscale	256 levels
Transmission time	< 3 seconds, JBIG at 33.6 Kbps (with Automatic Fall Back)
Back-up memory	Yes, 700 pages
Duplex transmission	Standard
Broadcasting	Up to 100 numbers

### OTHER OPTIONS

Paper feed (PF-470)	1 x 500-sheet tray Paper weight: 52-163 g/m <sup>2</sup> , original format A3-A5R, as alternative to PF-471 or high stand
Paper feed (PF-471)	2 x 500-sheet trays Paper weight: 52-163 g/m <sup>2</sup> , original format A3-A5R, as alternative to PF-470 or high stand
Finisher (DF-470+AK-470)	External hanging finisher, 500 sheets, max. A4, 3-position stapling (1 front, 1 rear and 2 central), 50 A4 sheets (max 90 g/m <sup>2</sup> ) or 25 A3 sheets
Memory expansion	1,024 MB MDDR2 144 DIMM
Stand	High: raises the multifunction device in the absence of the PF-470 and PF-471 trays

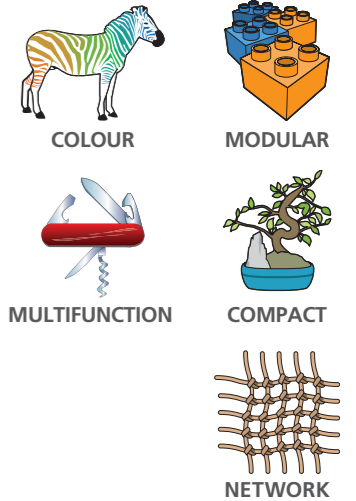

# d-COLOR MF2001plus

The new **colour multifunction system** that combines **professional quality** with the needs of users who require a product that is **easy to install, use and maintain.**



Performance referring to product use in optimal conditions. The right to vary technical features is reserved. Registered trademarks are the property of their respective owners.  
d-Color MF2001plus is distributed by Olivetti S.p.A.  
(12/12) - Codice: 28923-00

OLIVETTI S.P.A.  
VIA JERVIS 77  
10015 IVREA (TO) ITALY  
www.olivetti.com



**ALL-IN-ONE ARCHITECTURE**  
**ADF, DUPLEX, JOB SEPARATOR AS STANDARD**  
**PRINTING SPEED FOR COMPETITIVE DOCUMENT PRODUCTION**  
**(20-25 ppm B/W)**  
**COLOUR SCANNER WITH A SPEED OF 40 opm**  
**INTUITIVE TOUCH SCREEN FROM 4.3"**  
**DIRECT USB PRINTING AND SCANNING**  
**STANDARD MEMORY 1.5 GB**  
**JAVA AND WEB BASED APPLICATION MANAGEMENT**

# d-COLOR

## MF2001plus



Direct scan to USB



Operator panel with 4.3 inch touch screen

### PROFESSIONAL EQUIPMENT

The new Olivetti A3 multifunction system has a motor capable of printing up to **20 A4 colour pages per minute** with a print resolution of 600 dpi, ensuring a level of print quality highly appreciated even by the **most demanding users**.

d-Color MF2001plus has a **standard 1.5 GB memory**, enabling users to handle print queues of up to 10 users quickly and efficiently, and offering as standard the **private printing** function, essential for a product designed for small work groups.

### COMPETITIVE COSTS

d-Color MF2001plus is the new A3 colour multifunction system that, thanks to a **low initial outlay**, opens the doors to the professionalism of an A3 colour system for users who, for reasons of cost, have always opted for **A4 or monochrome products**. Furthermore, thanks to its **200K page maintenance cycles**, d-Color MF2001plus is particularly efficient in terms of maintenance costs. Great attention has also been paid to energy savings, having reduced **energy absorption in sleep mode to just 0.9W**, one of the lowest rates on the market today.



### OPTIONS

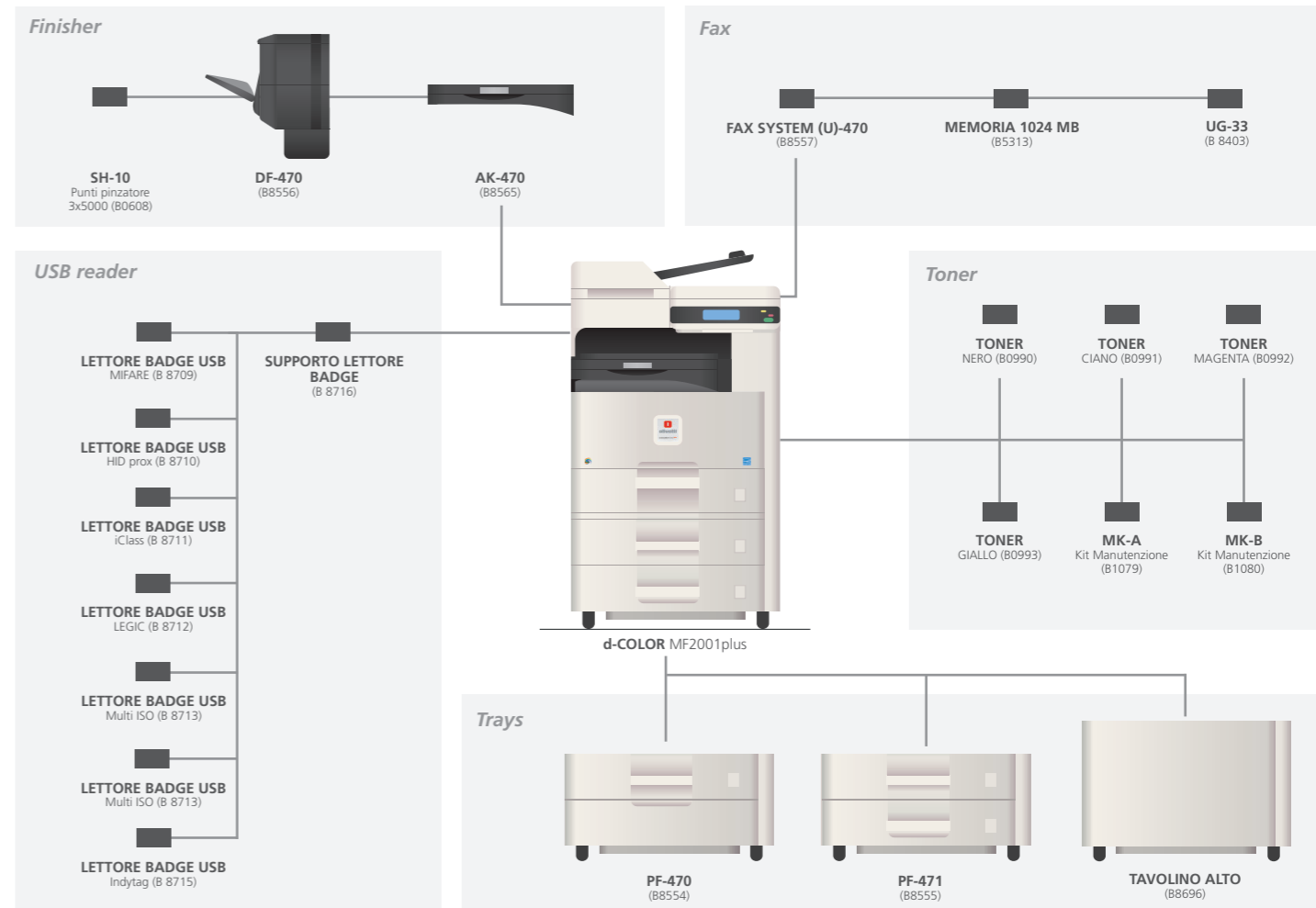

### USING SOFTWARE APPLICATIONS

d-Color MF2001plus implements the **JAWS platform (Java And Web Solutions)** to enable use of applications to boost product functionality.

**EasyScan 1.0.0\*** is an interesting application developed by Olivetti to maximise the advantages of the scanner function in heavy-duty environments, such as banks, insurance agencies, administration and accounting departments, and logistics companies. The EasyScan 1.0.0 application runs on many different Olivetti multifunctional devices, so that it can be used by customers with mixed-product installations.

\*Not available as standard